

Dimension Drawing

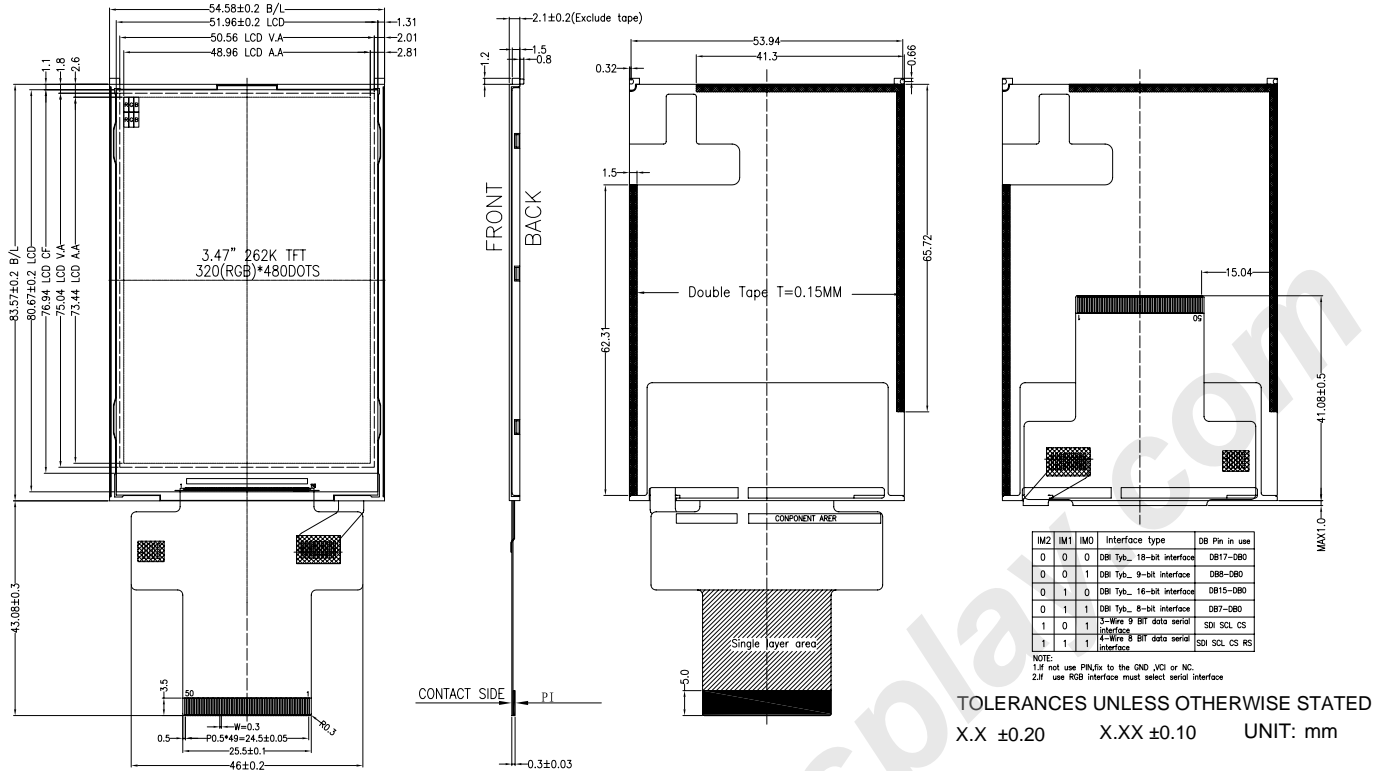

Feature:

1. Resolution is 320 (RGB) x 480 Pixel
2. +3.3V power supply
3. Display Mode is IPS , normally black
4. Display color is 65K/262K colors
5. Input Interface is 8/9/16/18-bits MCU interface
16/18-bits RGB interface ,3-line/4-line serial interface.
6. It could be matched resistive or capacitance touch panel
7. ROHS compliant

Interface Pin Connections

PIN NO.	Symbol	PIN NO.	Symbol
1	GND	26	DB3(B3)
2	VDD	27	DB2(B2)
3	VDD	28	DB1(B1)
4	IM0	29	DB0(B0)
5	IM1	30	GND
6	IM2	31	DOUT
7	RESET	32	DIN (SDA)
8	VSYNC	33	RDX
9	HSYNC	34	WRX (SCL)
10	PCLK	35	DCX
11	DE	36	CSX
12	DB17(R5)	37	LEDA
13	DB16(R4)	38	LEDA1
14	DB15(R3)	39	LEDA2
15	DB14(R2)	40	LEDA3
16	DB13(R1)	41	LEDA4
17	DB12(R0)	42	LEDA5
18	DB11(G5)	43	LEDA6
19	DB10(G4)	44	LEDA7
20	DB9(G3)	45	LEDA8
21	DB8(G2)	46	NC (TP-XR)
22	DB7(G1)	47	NC (TP-YD)
23	DB6(G0)	48	NC (TP-XL)
24	DB5(B5)	49	NC (TP-YU)
25	DB4(B4)	50	GND

Mechanical Data

Item	Standard	Unit
Module dimension	54.58 x 83.58 x 2.1	mm
Active area	48.96 x 73.44	mm
Dots size	0.153 x 0.153	mm
Screen size	3.5 (Diagonal)	inches

Absolute Maximum Rating

Item	Symbol	Standard			Unit
		Min	Typ	Max	
Supply voltage	VDD-VSS	-0.3	---	4.6	V
Supply Voltage (Logic)	VDDI	-0.3	---	4.6	

Electronical Characteristics

Item	Symbol	Condition	Standard			Unit
			Min	Typ	Max	
Input voltage	VCC	+3.0V	2.6	3.3	4.2	V
Viewing angle	θL	9 o'clock	70	80	----	degree
	θR	3 o'clock	70	80	----	degree
	θU	12 o'clock	70	80	----	degree
	θD	6 o'clock	70	80	----	degree
Contrast ratio	CR	Best viewing angle	400	500	----	----
White luminance	ΔL	θ=Φ=0°	350	400	----	cd/m ²
LED forward voltage	VF	25°C	----	3.2	3.3	V
LED forward current	IF	25°C Edge	----	160	170	mA
Storage temp.	TOP	----	-20	----	80	°C
Operation temp.	TST	----	-30	----	90	°C

Dimension Drawing

TOLERANCES UNLESS OTHERWISE STATED

X.X ±0.20 X.XX ±0.10 UNIT: mm

Feature:

1. Resolution is 240 (RGB) x 320 Pixel
2. +3.3V power supply
3. Display Mode is IPS , normally black
4. Display color is 65K/262K colors
5. Input Interface is 8/9/16/18-bits MCU interface
16/18-bits RGB interface ,3-line/4-line serial interface.
6. It could be matched resistive touch panel
7. ROHS compliant

Interface Pin Connections

PIN NO.	Symbol	PIN NO.	Symbol
1	GND	26	DB3(B3)
2	NC or TP-XR	27	DB4(B4)
3	NC or TP-YD	28	DB5(B5)
4	NC or TP-XL	29	DB6(G0)
5	NC or TP-YU	30	DB7(G1)
6	IOVCC	31	DB8(G2)
7	IOVCC	32	DB9(G3)
8	VDD	33	DB10(G4)
9	VDD	34	DB11(G5)
10	IM2	35	DB12(R0)
11	IM1	36	DB13(R1)
12	IM0	37	DB14(R2)
13	RESET	38	DB15(R3)
14	CS	39	DB16(R4)
15	DC(SCL)	40	DB17(R5)
16	WR(RS)	41	SDO
17	RD	42	GND
18	VSYNC	43	LEDA
19	HSYNC	44	LEDA1
20	ENABLE	45	LEDA2
21	DOTCLK	46	LEDA3
22	SDA	47	LEDA4
23	DB0(B0)	48	LEDA5
24	DB1(B1)	49	LEDA6
25	DB2(B2)	50	GND

Mechanical Data

Item	Standard	Unit
Module dimension	57.54 x 79.20 x 3.0	mm
Active area	48.6 x 64.8	mm
Dots size	0.2025 x 0.2025	mm
Screen size	3.2 (Diagonal)	inches

Absolute Maximum Rating

Item	Symbol	Standard			Unit
		Min	Typ	Max	
Supply voltage	VDD-VSS	-0.3	---	4.6	V
Supply Voltage (Logic)	VDDI	-0.3	---	4.6	

Electronical Characteristics

Item	Symbol	Condition	Standard			Unit
			Min	Typ	Max	
Input voltage	VCC	+3.0V	2.4	2.75	3.3	V
Viewing angle	θL	9 o'clock	70	80	----	degree
	θR	3 o'clock	70	80	----	degree
	θU	12 o'clock	70	80	----	degree
	θD	6 o'clock	70	80	----	degree
Contrast ratio	CR	Best viewing angle	500	700	----	----
White luminance	ΔL	θ=Φ=0°	350	400	----	cd/m ²
LED forward voltage	VF	25 °C	----	3.2	3.3	V
LED forward current	IF	25 °C Edge	----	120	130	mA
Storage temp.	T _{OP}	----	-20	----	80	°C
Operation temp.	T _{ST}	----	-30	----	90	°C