

## Dimension Drawing

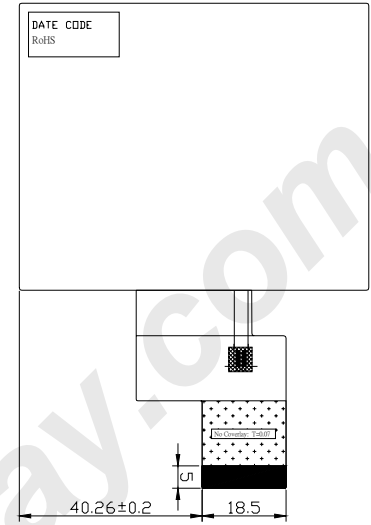
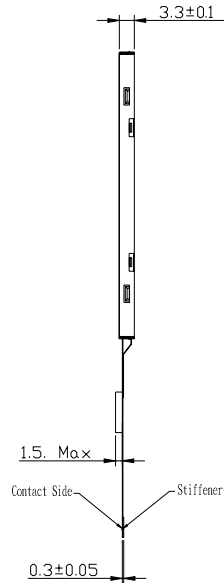
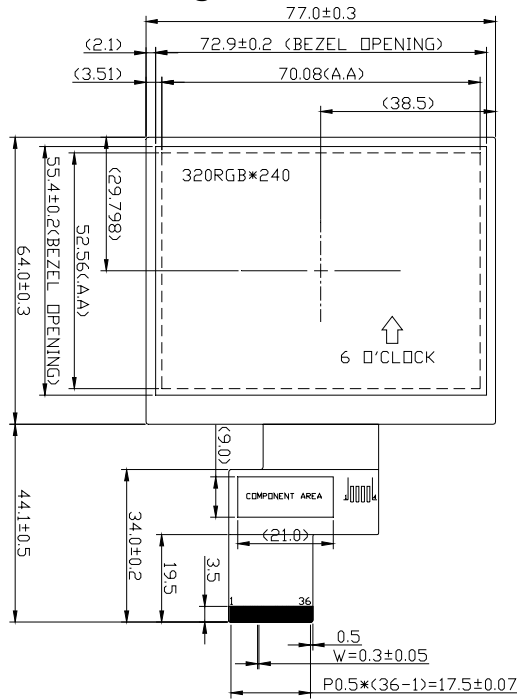

TOLERANCES UNLESS OTHERWISE STATED  
 X.X ±0.20    X.XX ±0.10    UNIT: mm

## Feature:

1. Resolution is 320 (RGB) x 240 Pixel
2. +3.3V power supply
3. Display Mode is TN, Normal White
4. Display color is 65K/262K colors
5. Input Interface is 8 bits 8080/6800 MCU system interface
6. It could be matched resistive or capacitance touch panel
7. ROHS compliant

## Interface Pin Connections

PIN NO.	Symbol	PIN NO.	Symbol
1	LED-A	19	DB15
2	LED-K	20	DB16
3	VDDIO	21	DB17
4	NC	22	WSYNC
5	NC	23	GND
6	NC	24	/CS
7	NC	25	R/W (WR)
8	NC	26	E (/RD)
9	NC	27	DC
10	NC	28	/RESET
11	NC	29	VDDIO
12	NC	30	VCI
13	NC	31	NC (XL)
14	DB10	32	NC (YD)
15	DB11	33	NC (XR)
16	DB12	34	NC (YU)
17	DB13	35	GND
18	DB14	36	GND

## Mechanical Data

Item	Standard	Unit
Module dimension	77.0 x 64.0 x 3.3	mm
Active area	70.08 x 52.56	mm
Dots pitch	0.219 x 0.219	mm
Screen size	3.5 (Diagonal)	inches

## Absolute Maximum Rating

Item	Symbol	Standard			Unit
		Min	Typ	Max	
Power supply	VDDIO	-0.3	---	4.0	V
Logic input voltage	Vci	VSS-0.3	---	5.0	

## Electronical Characteristics

Item	Symbol	Condition	Standard			Unit
			Min	Typ	Max	
Input voltage	VDDIO	+3.0V	3.0	3.3	3.6	V
Viewing angle	θL	9 o'clock	40	50	----	degree
	θR	3 o'clock	40	50	----	degree
	θU	12 o'clock	30	45	----	degree
	θD	6 o'clock	65	75	----	degree
Contrast ratio	CR	Best viewing angle	320	400	----	----
White luminance	ΔL	θ=Φ=0°	250	300	----	cd/m <sup>2</sup>
LED forward voltage	VF	25°C	----	19.2	20.0	V
LED forward current	IF	25°C Edge	----	20	22	mA
Storage temp.	TOP	----	-20	----	80	°C
Operation temp.	TST	----	-30	----	90	°C